

--Select--

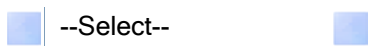

’† p ^’ [q]

Relay-Type Terminal Block

fsfbf/Pitch 25.5mm



Type Number	F150
Rating	AC660V 60A
Insulation Resistance	500V 100MΩ and over DC500V 100MΩ and over
Withstands Voltage	2500V @1.0× 1 minute and over AC2000V 1 minute and over
Compatible Wire	14.0mm ²
PDF download the (.pdf) datasheet	

General Tolerance ±0.5
Scale/Unit mm

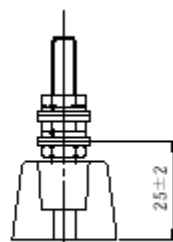
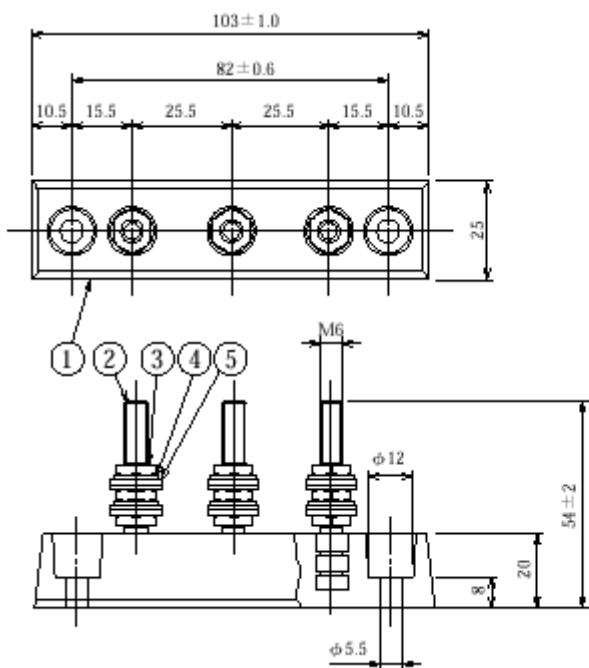

压着端子固定最下段位置
The lowest fixing position for clim-style terminal

Ordering Form: [Type No.] Compatible quick connect terminal JIS 14-6,22-6 (Ring type)
Connection screw (Conductive stud bolt): Tightening torque is 3.0N m.

Specifications.

Part No.	Part Name	Material	Standard	Size	Treatment	Remark
1	Base	Phenolic	UL			FBlack
2	Conductive	Brass	BSB	M6x1.0	Nickel-Plated	

	stud bolt					
3	fi fbfg Nut	%©“÷ Brass	BSB	”_ t t3.0	fj fbfPf <f fbfL Nickel-Plated	”_” Quantity3x3
4	f ofl < Spring washer	f” f“□_“÷ Phosphor bronze	PBW	”_ t t1.5	fj fbfPf <f fbfL Nickel-Plated	”_” Quantity2x3
5	f~f KfL < Flat washer	%©“÷ Brass	BSR	”_ t t1.0	fj fbfPf <f fbfL Nickel-Plated	”_” Quantity4x3

”_”i, ”_”w, □, †□¢, λ-”, >, ;”fJf^f” fO¥fTf“fvf<,;²” 9-],w
 -{” 1%oc<”” @” iTEL:03-3755-5711” A,□,½,**E-mail**” j” @,□,.,”<C” y,;²~A□□ ,¾,¾,³,¢i